



*North American Association
of Summer Sessions*
32nd Annual Conference

*Asheville, North Carolina
November 12-15, 1995*

North American Association of Summer Sessions 32nd Annual Conference

"Transitions"

TABLE OF CONTENTS

1995 NAASS Administrative Council	Page 2
General Information	Page 3
Extracurricular Activities	Page 4
Early Bird Events: Saturday, November 11	Page 6
First Day: Sunday, November 12	
New Summer Session Administrators' Workshop	Page 7
NAASS Standing Committee Meetings	Page 7
New Summer Session Administrators' Luncheon	Page 7
Administrative Council Meeting	Page 8
"Not-So-New" Administrators' Round Table	Page 8
Evening Reception and Entertainment	Page 8
Second Day: Monday, November 13	
First Plenary Session	Page 9
Concurrent Sessions	Page 9
Hotel Meeting Facilities	Page 10
Second Day: Monday, November 13	
Concurrent Sessions	Page 12
Regional Luncheons	Page 13
Second Plenary Session	Page 14
Concurrent Sessions	Page 14
President's Reception	Page 15
Third Day: Tuesday, November 14	
Buffet Breakfast and Third Plenary Session	Page 16
Fourth Plenary Session	Page 16
Concurrent Sessions	Page 16
Awards Reception and Madrigal Dinner	Page 18
Fourth Day: Wednesday, November 15	
Breakfast Buffet	Page 19
Annual Business Meeting	Page 19
Fifth Plenary Session	Page 19
Administrative Council Meeting	Page 19
1995 NAASS Standing Committees	Page 20

1995 NAASS ADMINISTRATIVE COUNCIL

"The Administrative Council is the governing body of the Association and shall consist of (a) the officers of the Association: the President, the President-Elect, and the Treasurer; (b) one vice-president from each of the geographical regions designated as Association regions in the Bylaws; (c) three At-Large Members; and (d) the immediate Past President." (*Article V, Section I, of the Constitution*)

President

Dori Beeks
Western Oregon State College

Northeastern Vice-President

Christopher Weir
Emerson College

President-Elect

Victor N. Kobayashi
University of Hawai'i at Manoa

Southern Vice-President

R. Clinton Parker
Appalachian State University

Past President

Sybil P. Smith
Boston University

Western Vice-President

Larry G. Cobb
San Diego State University

Treasurer

Sharon E. Alexander
University of Montana

At-Large Member

Donna R. Bafundo
George Mason University

Middle States Vice-President

Donna Scarboro
The George Washington University

At-Large Member

Lee A. Golden
University of Portland

North Central Vice-President

Patrick C. Runde
University of Wisconsin-Madison

At-Large Member

Gary W. Penders
University of California at Berkeley

* * * * *

Executive Secretary

Michael U. Nelson
11728 Summerhaven Drive
St. Louis, Missouri 63146-5444

GENERAL INFORMATION

Conference Registration: Complete the enclosed Conference Registration Form and submit it, along with the appropriate fees, to the address found on the Conference Registration Form *no later than November 3, 1995*. Make checks payable to "Western Carolina University/NAASS." All fees paid, less \$20.00, are refundable if the registration is cancelled before November 3, 1995.

The Basic Registration Fee includes: Sunday's evening reception, Monday's Continental Breakfast, Regional Luncheon, and President Dori Beeks' Evening Reception; Tuesday's Buffet Breakfast, Awards Reception, and Madrigal Dinner; Wednesday's Buffet Breakfast; and all refreshment breaks.

Additional Tickets: Additional tickets for spouses/guests are available for all nonmeeting functions. The fees for these activities are on the next few pages, under "Extracurricular Activities," and on the Conference Registration Form.

Multiple Institutional Registrations: A reduced registration fee is available to any institution sending more than two people to the Conference. The first two attendees pay the Basic Registration Fee (\$225.00 for NAASS members or \$310.00 for non-NAASS members); all additional registrants from that institution pay \$195.00 each. Please submit all registrations at the same time to ensure proper credit.

Hotel Reservations: A room reservation form has been included with your conference registration materials. To make a reservation by telephone, call the Grove Park Inn at 1-800-438-5800 and specify that you are attending the NAASS Conference. *The final date for securing guaranteed hotel reservations is October 13, 1995.* Deposits will be refunded or applied to alternate dates by calling 1-800-438-5800 before 5:00 p.m. (Eastern time) seven days prior to your scheduled arrival (see the enclosed Reservations Request Form).

Hotel Parking: Guest parking is provided in the hotel garage at no charge.

Transportation to the Grove Park Inn: See the accompanying information on Asheville, Air Transportation, and Transportation to the Grove Park Inn.

Weather: Asheville has a mild year-round climate, with an average high temperature of 67 degrees and an average low of 47 degrees. In November, the average range is 34 to 59 degrees.

Restaurants and Attractions: Asheville prides itself on the plethora of fine places to dine. Lists of restaurants will be available at the NAASS Hospitality Desk, but don't forget the Grove Park Inn's highly acclaimed weekend buffets in the Blue Ridge Dining Room and its 4-Diamond Horizons Restaurant. Also available will be a list of attractions, including nearby Mt. Mitchell (the highest peak in the eastern United States), the Thomas Wolfe Memorial in downtown Asheville, the Cherokee Indian Reservation, the Great Smoky Mountains Railway, the Western North Carolina Farmers' Market, and Historic Biltmore Village and Pack Place in the center city.

SATURDAY, NOVEMBER 11: 8:30 a.m.-7:00 p.m.

"Great Smoky Mountains Sampler"

Join host and guide Ray Rapp and historian Harley Jolley for a "Great Smoky Mountains Sampler." We begin with a short ride on the Blue Ridge Parkway as Professor Jolley, one of the leading interpreters of the Southern Appalachians, narrates the history of this 469-mile highway that connects the Shenandoah and Great Smoky Mountains National Parks.

We stop at Waterrock Knob, considered by many to be the most spectacular view of the Great Smokies and one of the most scenic vistas along the Blue Ridge Parkway. From the parkway we board a Great Smoky Mountains Railway train for a trip from Dillsboro to Bryson City, North Carolina, and are served a gourmet luncheon (linens, uniformed waiters, etc.) in one of the railroad's two new dining cars. Along the way, Ray relates the history of the heartbreak and hard times associated with the carving of the Western North Carolina Railroad into the rugged wilderness of the Southern Appalachians.

We follow the scenic Tuckasegee River and pass through the 836-foot long Cowee Tunnel, hand-dug by convict laborers over 100 years ago and haunted, according to local legend, by the ghosts of the 19 inmates drowned during its construction. See, too, the magnificent Great Smoky Mountains and view cascading waterfalls, whitewater rapids, and the remains of the train wreck staged for the movie *The Fugitive*, starring Harrison Ford.

After our return to Dillsboro, visit the Cherokee Indian Reservation and hear the story of the native-American removal, "The Trail of Tears," as told by tribal leaders who greet you. Time will be given, too, to those who wish to visit the much heralded Cherokee Craft Center. To end the day, dinner is served at the Jarrett House in Dillsboro, an inn famous for its family-style meals since the arrival of the Western North Carolina Railroad in 1884. Cost: \$65 (includes bus transportation, railway ticket, luncheon and dinner, plus a reception in the Rail Museum).

SATURDAY, NOVEMBER 11: 1:00-5:30 p.m.

First Annual "Sam/Tarbet Golf Tournament"

Members and their guests will have the opportunity to participate in the first annual (we hope!) golf tournament, named for two of our most ardent and famous golfing colleagues, Norm Sam and the late Don Tarbet. Hosted by southern regional vice-president Clinton Parker, the game will be played on the 18-hole, par 72, championship golf course sculpted by famed designer Donald Ross. The course, located immediately in front of our hotel, combines manicured greens and tree-lined fairways with panoramic mountain views. The format will be "Captain's Choice Best Ball" in order to permit any skill level to participate. Greens fees and cart will cost \$60. Clubs are available for rent in the Pro Shop. *A minimum of 16 players is required with preregistration an absolute must.*

EXTRACURRICULAR ACTIVITIES

SUNDAY, NOVEMBER 12: 8:00-9:00 p.m.

"Bits and Pieces"

After the Sunday evening reception, the Southern Appalachian Repertory Theatre (SART) presents a musical revue, in Heritage Ballroom C of the hotel's Sammons Wing, designed ". . . to remind you of those happy moments in your life when you loved and were loved." The production features songs from Broadway's leading shows including *The Fantasticks*, *Camelot*, *Fiddler on the Roof*, and *Guys and Dolls*, as well as a host of other familiar and loved numbers. A recent review stated: "There's nothing too complicated about *Bits and Pieces*, a sweet, sentimental musical review. Powered by an exceptional cast, the show breezes through this nostalgic musical journey, stopping only to let each performer shine." Cost: \$10.

TUESDAY, NOVEMBER 14: 12:45-5:30 p.m.

Tour of the Biltmore Estate

Celebrate the centennial anniversary of America's largest residence, Biltmore House, with lunch and tours of the famed 255-room mansion, its gardens, and its winery. The French Renaissance chateau, built for George W. Vanderbilt and opened on Christmas Eve 1895, features a collection of 50,000 original art works (including pieces by Albrecht Durer, John Singer Sargent, Pierre Auguste Renoir, and others), antiques, and furnishings collected by Vanderbilt on his world travels.

Elaborate Victorian-style Christmas decorations will be displayed throughout the house along with a special exhibit of 100 never-before-seen treasures, including paintings by Monet and Whistler, silver pieces by DeLamerie and Crespin, rare books and prints, and archival photographs chronicling the life of the estate's creator.

Enjoy lunch in the 8,000-acre estate's Deer Park Restaurant followed by a tour of the mansion with its 32 guest rooms, Winter Garden, Tapestry Gallery, Billiard Room, gymnasium, indoor swimming pool, bowling alley, library, and countless sitting rooms. We can see how architect Richard Morris Hunt equipped the house with central heat, mechanical refrigeration, electric lights and appliances, and indoor bathrooms—all unheard of luxuries in a private residence at the turn of the century.

After visiting the house, the tour progresses to the estate's exquisitely maintained gardens and grounds designed by Frederick Law Olmsted, the father of landscape architecture in America. Our excursion to Biltmore continues with a tour of the estate's winery, located in the original dairy barns, before we proceed to the Tasting Hall to sample some of Biltmore's award-winning wines. A visit to the 3,000-square foot Wine Shop, with its selection of gourmet foods, giftware, wine accessories, and Biltmore wine, concludes the afternoon's outing. Cost: \$42 (includes transportation, admission to the Biltmore Estate, and luncheon).

EXTRACURRICULAR ACTIVITIES

WEDNESDAY, NOVEMBER 15: 1:00-5:30 p.m.

"An Asheville Sampler"

The city made famous by Thomas Wolfe in *Look Homeward Angel* offers the spectacular beauty of the Great Smokies and Blue Ridge Mountains and the endless variety of interesting things to do and see.

We start in the "Great Room" at the Grove Park Inn, where such literary lights as F. Scott Fitzgerald had temporary residence. Next, the bus takes us to St. Mary's and the neighborhood that provides the backdrop for a number of novels by the noted contemporary author Gail Godwin. You learn about the boyhood of another renowned Asheville native at the Thomas Wolfe Memorial in downtown Asheville, where you discover more art deco architecture than in any other southeastern city except Miami.

From there we go to Biltmore Village, built as a model community to service George Vanderbilt's estate a century ago, where you have a chance to shop in the restored English-style houses that now contain intriguing shops and galleries. We also go inside All Souls Cathedral, opened as the chapel for the Biltmore Estate in 1895 and the only extant church of the seven designed by the famed architect of Biltmore House, Richard Morris Hunt.

From Biltmore Village we proceed to the Southern Highland Handicraft Guild's Folk Art Center, featuring the museum gallery, craft exhibits, demonstrations, and its world-renowned craft shop. After a short overview of the Blue Ridge Parkway's history, we travel to Craggy Gardens on the scenic highway and view some of the most spectacular scenery to be found along the 470-mile highway. Cost: \$21 (includes transportation and all admission fees).

EARLY BIRD EVENTS: Saturday, November 11

8:00 a.m.-8:00 p.m. **EARLY REGISTRATION** Carolina Walk

8:30 a.m.-7:00 p.m. **"GREAT SMOKY MOUNTAINS SAMPLER"**
(See "Extracurricular Activities" on page 4.)

1:00-5:30 p.m. **FIRST ANNUAL "SAM/TARBET GOLF TOURNAMENT"**
(See "Extracurricular Activities" on page 4.)

7:30-9:00 p.m. **EARLY BIRD SOCIAL** President's Suite
President Dori Beeks will be "at home" to any and all wishing to enjoy a little refreshment, some stimulating conversation, and the opportunity to socialize informally with new acquaintances and old friends.

- 1:35-4:00 p.m. **NEW SUMMER SESSION** Coolidge Rooms
ADMINISTRATORS' WORKSHOP D & E
- 1:35 p.m. A brief overview of the afternoon activities is followed by concurrent sessions. New administrators will attend one 30-minute session of their choice during each time slot. These sessions will allow for in-depth exploration of the topic area.
- 1:40 to (1) How to create the perfect schedule.
2:10 p.m. (2) Putting together your catalog.
(3) Salaries and contract issues.
- 2:15 to (4) Programming and innovation.
2:45 p.m. (5) How to market your summer program.
(6) How to develop a summer budget.
- 2:50 to Summary: Implementation Strategies for Summer Programs-
4:00 p.m. A Case Study Approach
- 1:45-4:00 p.m. **ADMINISTRATIVE COUNCIL MEETING** Grove Room
- 4:30-5:45 p.m. **"NOT-SO-NEW" ADMINISTRATORS'** Hoover Rooms
ROUND TABLE H & J
- This is to be an open and free-wheeling discussion session, conducted in a very informal manner, and covering whatever topics those in attendance would like to have addressed. Anyone may raise a question and anyone may respond.
- The panelists bring many years of summer session experience to the round table, and they represent public and private institutions. They may not have all the answers, but they certainly have some questions. Here is the perfect opportunity to raise that knotty question, which has been bothering you for so long, or to help others now experiencing the same problems that you have faced . . . and solved!
- Moderator: Leslie J. (Les) Coyne, Indiana University
Panelists: Nancy M. Tischler, The Pennsylvania State University
Marcy Ullom, University of Miami
Recorder: Larry G. Cobb, San Diego State University
- 6:30 p.m. **EVENING RECEPTION** Grand Ballroom A
AND ENTERTAINMENT
- To help unwind at the end of the day, our North Carolina colleagues host a reception (with substantial hors d'oeuvres) and provide some pleasant diversion, as the Mars Hill College Jazz Band tenders some toe-tapping musical entertainment.
- 8:00-9:00 p.m. **SOUTHERN APPALACHIAN REPERTORY** Heritage
THEATRE PRESENTATION Ballroom C
(See "Extracurricular Activities" on page 5.)

- 8:00 a.m. **NAASS HOSPITALITY** Vanderbilt Wing
AREA OPEN Level 8 Atrium Lobby
- 8:00-8:30 a.m. **CONTINENTAL BREAKFAST** Outside Grand Ballroom
- 8:30-8:45 a.m. **MARS HILL COLLEGE BAILEY MOUNTAIN CLOGGERS**
- 8:45-9:45 a.m. **FIRST PLENARY SESSION** Grand Ballroom A
"Positive Turbulence: A Creative Leader's Responsibility"
- Presiding: Dori Beeks, Western Oregon State College
President of NAASS
- Welcome: The Hon. Russ Martin
Mayor of Asheville, North Carolina
- Overview: Victor N. Kobayashi, University of Hawai'i at Manoa
Chair, Conference Program Committee
- Introduction: John J. Young, University of North Carolina-Greensboro
- Speaker: Dr. Stanley S. Gryskiewicz, Senior Fellow
Center for Creative Leadership, Greensboro, North Carolina
Dr. Gryskiewicz, an international leader in the field of innovative management, discusses how to develop and maintain a climate that supports creativity in an institutional setting.

10:00-11:30 a.m. **CONCURRENT SESSIONS**

Coffee, tea, and other refreshment will be available in each of the Concurrent Session meeting rooms.

- Session 1** **Fourth Annual Research Forum:** Coolidge Rooms
Part A D & E
- (1) The *Joint Statistical Report* can be a useful instrument for Summer Session administrators. Join a discussion of the conclusions of the research, how the *Report* can be used, and how customized versions of the *Report* can be provided to individual Summer Session directors.
- (2) Research on course scheduling, academic and student service needs, and program and faculty evaluation are discussed by Alice Dionne. Focus groups were used to obtain information for the development of a survey, which was given to a large group of students attending the 1993 and 1994 Summer Sessions.
- Moderator: Pamela Castellanos, Saint Xavier University
- Presenters: (1) Lee E. Golden, University of Portland
(2) Alice Dionne, University of Northern Colorado
- Recorder: Paul H. Blackwell, Samford University

HOTEL MEETING FACILITIES

SAMMONS WING LOBBY LEVEL

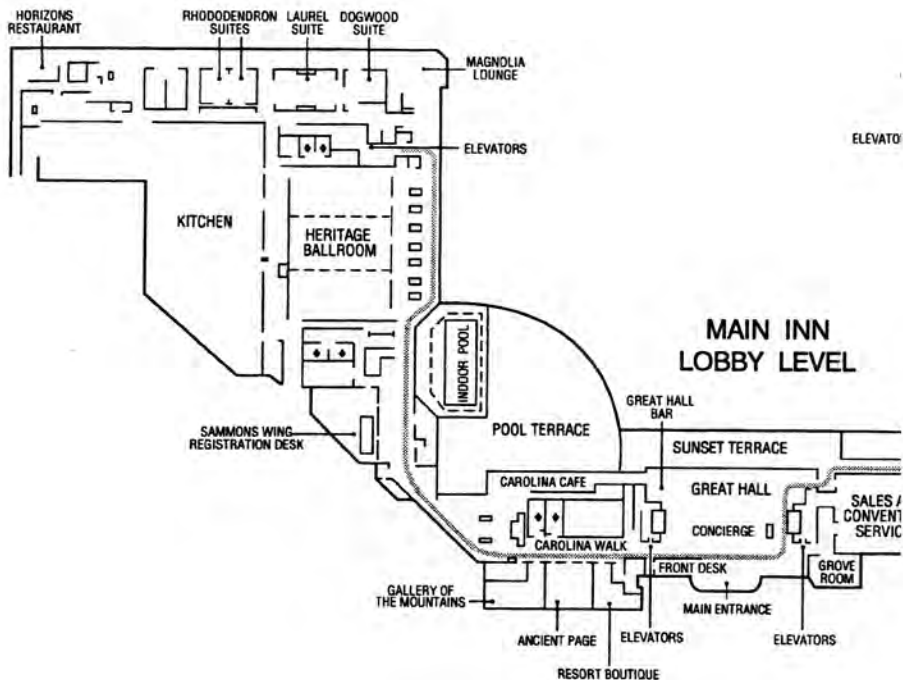

The
Grove Park Inn
Resort®

VANDERBILT WING LEVEL 10

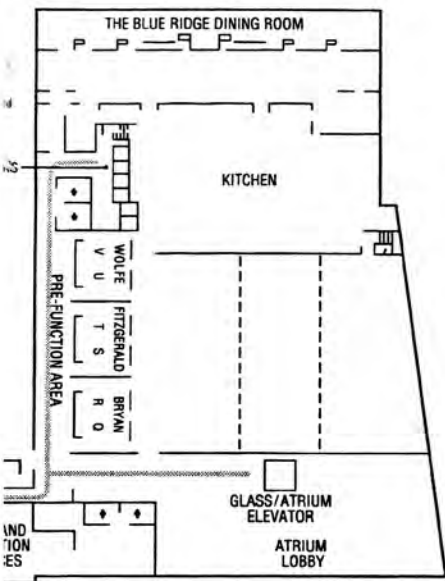

VANDERBILT WING LEVEL 8

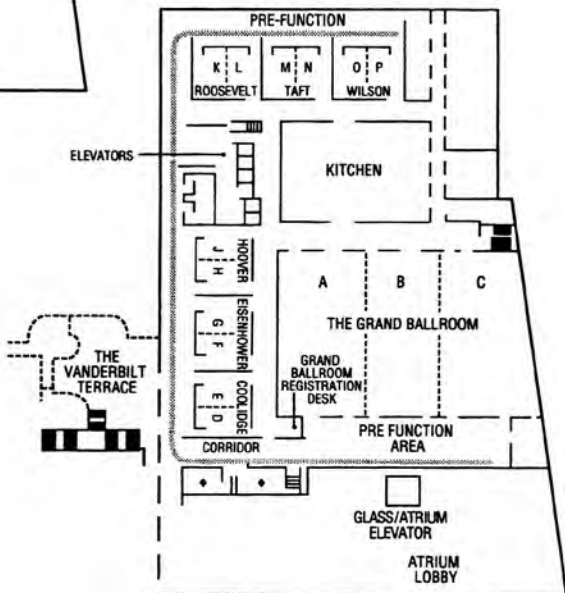

10:00-11:30 a.m. **CONCURRENT SESSIONS (continued)**

Session 2 Embraceable U: The Sometimes Eisenhower Rooms
Intimate Relationship Between F & G
Continuing Education and Summer Session

Summer Sessions sometimes fit comfortably with Continuing Education in a university's organizational set-up, and sometimes uncomfortably. Some universities are considering wedding CE and Summer together into the same unit, while others are planning a divorce, creating two separate units. Others are re-marrying or re-divorcing in the endless wheel of cyclic karma. Join a panel that discusses the pros and cons of the eternal mystery of whether "To CE or Not CE."

Organizer: Neal A. Ferguson, University of Nevada, Reno

Moderator: Joseph M. Kissane, Columbia University

Presenters: Neal A. Ferguson, University of Nevada, Reno
 Gary W. Penders, University of California at Berkeley
 Judith Ruderman, Duke University

Recorder: Neal A. Ferguson, University of Nevada, Reno

Session 3 Transitions: International Hoover Rooms
and Global Perspectives H & J

Policies and procedures in summer session—from an international perspective—are discussed, as well as international programs in summer.

Organizer: M. Joanne (Jody) Fisher, Loyola Marymount University

Moderator: J. Terry Iversen, University of Illinois

Presenters: M. Joanne (Jody) Fisher, Loyola Marymount University
 John R. Johnson, UCLA
 Lilieth H. Nelson, University of the West Indies
 Walter Uegama, University of British Columbia

Recorder: Patrick C. Runde, University of Wisconsin-Madison

Session 4 Transitions: Programs for Gifted Roosevelt Rooms
and Talented Children/Teens K & L

Our college and university campuses are in a unique position to provide enriching experiences for youth during the summer that appeal both to the students as well as their parents.

Moderator: John H. Leffler, Montclair State University

Presenters: Ronald A. Ross, Drew University
 Patricia Palmer Sine, The Johns Hopkins University
 Richard O. Taubald, Montclair State University
 John J. Young, University of North Carolina at Greensboro

Recorder: John F. Cudd Jr., North Carolina State University

Noon-1:30 p.m. **REGIONAL LUNCHEONS**

Members are invited to renew old acquaintances and meet new regional colleagues by joining them at luncheon. This is an excellent opportunity for newer members to begin the networking process. Some business of regional interest may also be conducted.

Middle States Region Taft Room M

Members from Delaware, District of Columbia, Maryland, New Jersey, Pennsylvania, Virginia, and West Virginia.

Presiding: Regional Vice-President Donna Scarborough
The George Washington University

North Central Region Taft Room N

Members from Illinois, Indiana, Iowa, Kansas, Kentucky, Manitoba, Michigan, Minnesota, Missouri, Nebraska, North Dakota, Ohio, South Dakota, and Wisconsin.

Presiding: Regional Vice-President Patrick C. Runde
University of Wisconsin at Madison

Northeastern Region Wilson Room O

Members from Connecticut, Maine, Massachusetts, New Brunswick, New Hampshire, New York, Newfoundland, Nova Scotia, Ontario, Prince Edward Island, Quebec, Rhode Island, and Vermont.

Presiding: Regional Vice-President Christopher Weir
Emerson College

Southern Region Fitzgerald Rooms S & T

Members from Alabama, Arkansas, Florida, Georgia, Louisiana, Mississippi, North Carolina, Oklahoma, Puebla (Mexico), Puerto Rico, South Carolina, Tennessee, Texas, the Virgin Islands, the West Indies, and the states of Mexico contiguous to these states.

Presiding: Regional Vice-President R. Clinton Parker
Appalachian State University

Western Region Blue Ridge Dining Room

Members from Alaska, Alberta, Arizona, British Columbia, California, Colorado, Hawai'i, Idaho, Montana, Nevada, New Mexico, Oregon, Saskatchewan, Utah, Washington, Wyoming, and the states of Mexico contiguous to these states.

Presiding: Regional Vice-President Larry G. Cobb
San Diego State University

SECOND DAY: Monday, November 13

1:45-3:00 p.m. **SECOND PLENARY SESSION** Grand Ballroom A
Summer Session and Distance Education

Join a discussion on how some university summer sessions are involved in the high-tech world of distance.

Moderator: H. Keith Spears, Marshall University
Panelists: James A. Brown, Lehigh University
Louis R. Jensen, Indiana State University
Recorder: Libby Kay, University of British Columbia

3:15-4:45 p.m. **CONCURRENT SESSIONS**

Afternoon refreshments will be available in each of the Concurrent Session meeting rooms.

Session 5 Fourth Annual Research Forum: Coolidge Rooms
Part B D & E
Eliciting Student Views

Practical methods are presented for obtaining information about student views of our Summer Sessions. Chris Weir examines the qualitative side, as he discusses the use of focus groups; Sharon Randall and Tom Kowalik address the quantitative aspect of the problem as they show how to design and use survey instruments.

Moderator: Ron L. Wasserstein, Washburn University of Topeka
Presenters: Thomas F. Kowalik, S.U.N.Y. at Binghamton
Sharon L. Randall, S.U.N.Y. at Binghamton
Christopher Weir, Emerson College
Recorder: Megs Shea, S.U.N.Y. at Stony Brook

Session 6 Summer Academe Eisenhower Rooms F & G

A journal devoted to summer sessions is in the making. Join this discussion of the journal. Learn how to submit manuscripts, consider suggested topics for articles, and much more. Led by David Schejbal, Editor of *Summer Academe*, and members of the editorial board.

Moderator: David Schejbal, Northwestern University
Members: Victor N. Kobayashi, University of Hawai'i at Manoa
Judith Ruderman, Duke University
Sybil P. Smith, Boston University
Recorder: Paul J. Will, S.U.N.Y.-College at Oswego

Session 7 Transitions: Weekend Courses Hoover Rooms
and Programs H & J

Thinking about starting a weekend college program in summer session, or revitalizing one already in place? Panelists discuss information on developing, marketing, and

3:15-4:45 p.m. CONCURRENT SESSIONS (continued)

sustaining weekend college programming in summer session and throughout the academic year. Topics also include needs assessment, programming, and a holistic approach to marketing.

Moderator: Joan M. Donnelly, Keene State College

Presenters: Carol Dunn Brown, North Central College
Pamela Castellanos, Saint Xavier University
John LaBrie, University of Southern Maine

Recorder: Suzanne Crawford, Bowling Green State University

Session 8 Transitions: On-line Summer Catalogs and Schedules Roosevelt Rooms K & L

The latest thing is having catalogs and class schedules be available on computer networks open to students—some on local networks and others that are global, including the World Wide Web. Some see the potential of catalogs available at an instant to a potential student thousands of miles away.

Will going on-line reduce costs of postage, etc.? Or will it lead to a Brave New World of huge additional expenses?

Moderator: Thomas F. Miller, University of Wisconsin-Eau Claire

Presenters: Debra Barger, California State University-Chico
Larry Gingrich, S.U.N.Y. at Buffalo

Recorder: James L. Murphy, University of North Carolina-Chapel Hill

5:30-7:00 p.m. PRESIDENT'S RECEPTION Grand Ballroom A

As we are meeting in an area long-renowned for the arts, President Dori Beeks has invited Norman S. Watt, Honorary Life Member and entrepreneur extraordinary, to present his latest collection of original oil paintings and allow his colleagues the chance (some say "challenge") to name these "unique" treasures.

Those familiar with Norm's annual **World's Worst Art** show and auction are once again presented the opportunity to participate in a fun-filled exercise. Our newer members are enthusiastically encouraged to join in the fun.

7:00 p.m. DINNER ON YOUR OWN

THIRD DAY: Tuesday, November 14

7:30 a.m. **NAASS HOSPITALITY** Vanberbilt Wing
 AREA OPEN Level 8 Atrium Lobby

7:45-8:30 a.m. **BUFFET BREAKFAST** Grand Ballroom B

8:15-8:30 a.m. **APPALACHIAN STATE UNIVERSITY CHAMBER SINGERS**

8:30-9:30 a.m. **THIRD PLENARY SESSION** Grand Ballroom B
 "Looking for Daisy Mae--A Profile
 of the People of Southern Appalachia"

Listen to 20 minutes of a humorous, insightful look at the people of the Southern Highlands and one which smashes the stereotype of Snuffy Smith as the typical mountaineer.

Presiding: Raymond C. Rapp, Mars Hill College
Speaker: Dr. Pat Beaver, Professor of Anthropology
Appalachian State University

9:45-10:45 a.m. **FOURTH PLENARY SESSION** Grand Ballroom A
 Creative and Innovative Programs Workshop

Each year, nominations are sought for the Creative and Innovative Program awards in the categories of administrative, credit, and noncredit programs. This session will highlight the 1995 finalists in each of these areas. Join the finalists as they give short presentations about their programs. The winners will be announced and the awards presented at the Awards Reception on Tuesday evening.

Presiding: Nora Reynolds, University of North Carolina-Greensboro

11:00-12:30 p.m. **CONCURRENT SESSIONS**

Session 9 Fourth Annual Research Forum: Coolidge Rooms
 Part C D & E

Liz Grobsmith discusses and evaluates a major student satisfaction survey performed in summer 1995, with methodology and research design and results presented. Sharon Alexander reports on how innovation during the summer session has spread to other sessions, with particular emphasis on self-supporting programs. Anita McDonald presents the results of a newly established program for instructor evaluation during the summer session. The evaluation parallels that of the academic year and allows for interesting comparisons among terms by a variety of factors.

Organizer: Ronald L. Wasserstein, Washburn University of Topeka
Moderator: Allan Fanjoy, University of Delaware
Recorder: Pamela Castellanos, Saint Xavier University

11:00-12:30 p.m. **CONCURRENT SESSIONS (continued)**

**Session 10 Transitions: Innovative Approaches Roosevelt Rooms
to Innovative Programs K & L**

Summer Session leaders are also leaders in innovative programs, and these often require innovative approaches in administration and financing. Join in this discussion by bringing in your ideas.

Moderator: Lois N. Glasser, Rutgers University-New Brunswick

Presenters: Michael V. DeRensis, S.U.N.Y. at Albany

Raymond R. Lagesse, S.U.N.Y.-College at Geneseo

Recorder: Jean Lenzi, McGill University

**Session 11 Strategic Management of Summer Hoover Rooms
Sessions in Research Universities H & J**

Many research institutions are undergoing serious re-allocation problems. Al Taylor has been researching the management approaches used to cope with these problems and how summer session administrators are responding to these institutional problems.

Moderator: Helen P. Warren, The Pennsylvania State University

Presenter: Alton L. Taylor, University of Virginia

Respondent: Jack K. Johnson, University of Minnesota, Twin Cities

Respondent: Judith Ruderman, Duke University

Recorder: Kei Quinlan, University of Washington

**Session 12 Focus on NAASS: Eisenhower Rooms
An Open Discussion with NAASS Leadership F & G**

An open-ended discussion between the members and the current leadership of NAASS. Interact with the key officers to discuss new ideas that move the Association into the 21st century.

Moderator: Dori Beeks, President of NAASS

Panelists: Sharon E. Alexander, Treasurer

Victor N. Kobayashi, President-Elect

Sybil P. Smith, Past President

Michael U. Nelson, Executive Secretary

Recorder: K. Jil Warn, University of California at San Diego

12:45-5:30 p.m. **OPTIONAL TOUR OF BILTMORE HOUSE, ITS
GARDENS, GROUNDS, AND WINERY**

(See "Extracurricular Activities" on page 5.)

- 8:00-8:30 a.m. **BREAKFAST BUFFET** Grand Ballroom B
- 8:30-9:00 a.m. **ANNUAL BUSINESS MEETING** Grand Ballroom B
Committee reports will be delivered, old and new business will be addressed, the 1995 Fiscal Year report will be reviewed, and the 1996 Fiscal Year budget will be submitted and voted upon.
- Presiding: Dori Beeks, President of NAASS
Reporting: Sharon E. Alexander, Treasurer of NAASS
Raymond R. Lagesse -- Conference Site Selection Committee
Michael U. Nelson -- Membership Committee
Sybil P. Smith -- Nominations and Elections Committee
Ronald L. Wasserstein -- Research & Publications Committee
- Recorder: Michael U. Nelson, Executive Secretary of NAASS
- 9:00-10:30 a.m. **FIFTH PLENARY SESSION** Grand Ballroom A
Catalog Clinic
The catalog clinic team will evaluate submitted summer catalogs on the basis of their success in communicating to a variety of audiences, attention to visual detail, creativity, efficiency, and success as a tool of public relations.
We will discuss the decision-making process that leads to getting a good product delivered on time and present some insights into the advantages of different approaches, including in-house desktop publishing.
To be evaluated, catalogs must be submitted by September 30. (*See July issue of the Newsletter for address.*)
- Panelists: Kerry Gilbert, Sonoma State University
Carl Jensen, University of Southern Colorado
Peter Rosenblum, Seton Hall University
Karen H. Sibley, Brown University
- 10:30-10:45 a.m. **REFRESHMENT BREAK** Outside Grand Ballroom
- 10:45 a.m.-noon **FIFTH PLENARY SESSION** Grand Ballroom A
(continued)
The Catalog Clinic will continue after the break.
- 12:00 noon **32nd ANNUAL CONFERENCE ADJOURNMENT**
- 12:30-2:00 p.m. **ADMINISTRATIVE COUNCIL** Coolidge Room D
MEETING
- 1:00-5:30 p.m. **"AN ASHEVILLE SAMPLER"**
(See "Extracurricular Activities" on page 5.)

Committee members are expected to attend their respective **Standing Committee Meetings** at 10:00 a.m. on Sunday, November 12, and then accompany a new member to the **New Summer Session Administrators' Luncheon** at noon.

Conference Site Selection

Raymond R. Lagesse, Chair
Judith W. Carr
K. Lloyd Carswell
William T. Emrick
Verla Fish
James L. Murphy
R. Clinton Parker
Gary W. Penders

Creative and Innovative Awards

Nora Reynolds, Chair
Bill E. Bompart
John E. Cech
Rina DeRose-Swinscoe
Martha Sue Harris
Robert C. Herold
John H. Leffler
Karen H. Sibley
Janet M. Wagner

Finance

Sharon E. Alexander, Chair
James A. Brown
Karen L. Crawford
John LaBrie
James L. Murphy
Alton L. Taylor
Robert L. Trewatha

Nominations and Elections

Sybil P. Smith, Chair
John F. Cudd Jr.
Jack K. Johnson
Nancy M. Tischler
K. Jil Warn

Research and Publications

Ronald L. Wasserstein, Chair
Sharon E. Alexander
Pamela Castellanos
Allan Fanjoy
Lee A. Golden
Elizabeth S. Grobsmith
Lilieth H. Nelson
Donald Piper
Janet Dietrick Rooney
Janet H. Stevenson

Publications (subcommittee)

M. Joanne (Jody) Fisher, Chair
Pam Brown
Hilda Grossman
Jack K. Johnson
Rosemary W. Owens
Michele V. Price
Patricia P. Sine
John J. Young

NOTE: Anyone interested in serving on one of these committees in 1996 should contact the appropriate committee chair or President-Elect Victor Kobayashi. Committee assignments are made after the first of the year.

Hosted by
Appalachian State University
Mars Hill College
Western Carolina University



The
Grove Park Inn
Resort®